

Gross External Area
43.28 m2

Gross Internal Area
39.60 m2

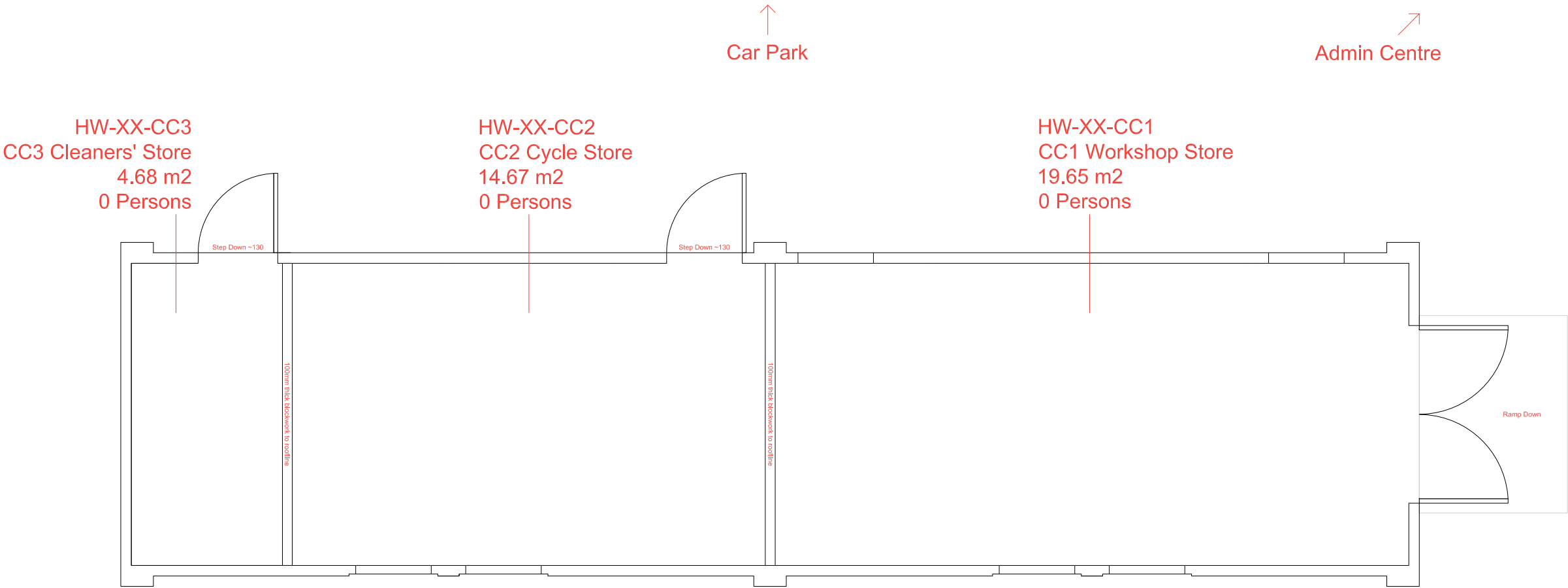

3rd Angle Projection U.N.O.

Do not scale this print.

Notes

Rev	Comment	By	Date
-----	---------	----	------



Estates Department
Dunholme Villa
Park Campus
Cheltenham
GL50 2RH
t: 01242 714 888

Drawing Status
As Built

Campus Location
**Hardwick Campus
Cheltenham GL50 4BS**

Drawing Title
**Store by Thames
Ground Floor
Floor Plan**

Scale	Drawn	Check	Rev.
1:50 @ A3	SW		01

Date
21-04-2023

Drawing Number
HW-XX-0-FP